

ALANDALOSIA

FOR AIR OUTLET

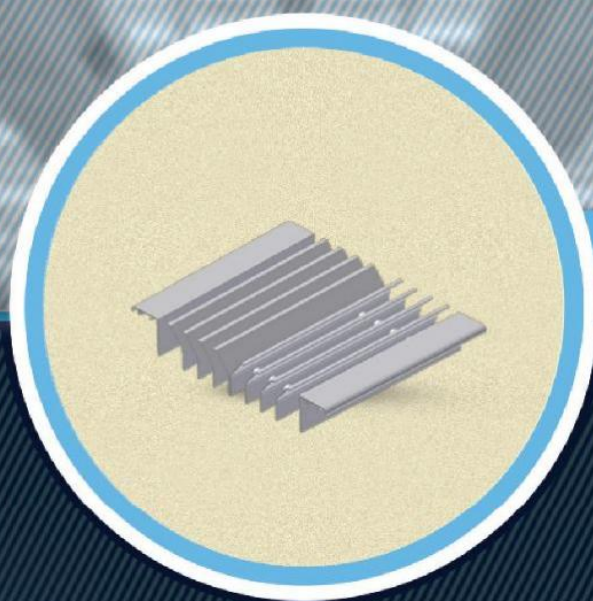

CATALOGUE **NO 6**

LINEAR CEILING DIFFUSER



Air Outlet

Andalosalosia

OUR PRODUCTS

SELECTION GUIDE

- 1- SQUARE CEILING DIFFUSER
- 2- ROUND CEILING DIFFUSER
- 3- SWIRL DIFFUSER
- 4- PERFORATED CEILING DIFFUSER
- 5- LINEAR SLOT DIFFUSER

6- LINEAR CEILING DIFFUSER

- 7- LINEAR BAR GRILL
- 8- REGISTER
- 9- FLOOR & PERFORATED FLOOR GRILL
- 10- TRANSFER GRILL
- 11- ACCESS PANEL
- 12- LOUVER
- 13- SAND TRAP LOUVER
- 14- JET NOZZLE
- 15- BALL JET NOZZLE
- 16- DRUM JET NOZZLE
- 17- DISC VALVE
- 18- NON RETURN DAMPER (SHUTTER)
- 19- VOLUME DAMPER
- 20- FIRE DAMPER
- 21- SMOKE DAMPER
- 22- DUCT ACCESS DOOR

....

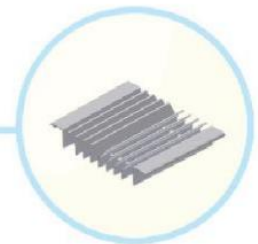

Air Outlet

Andalousia

INTERTEK

INTRODUCTION

The linear ceiling diffusers with one or two-sided discharge are especially suitable for air supply through ceilings. They distribute the air along the ceiling and can be used in very low rooms high. The linear ceiling diffusers feature excellent induction.

Mixing of the air jets with the room air and thus the heat exchange begin in the immediate neighbourhood of the diffuser. Therefore, warmer and particularly colder air can be supplied without draft effects.



SPECIFICATIONS

MATERIAL

Extruded aluminium throughout.

CONSTRUCTION

Frame held together using punched steel corners. Blades secured using expanded aluminium bars.

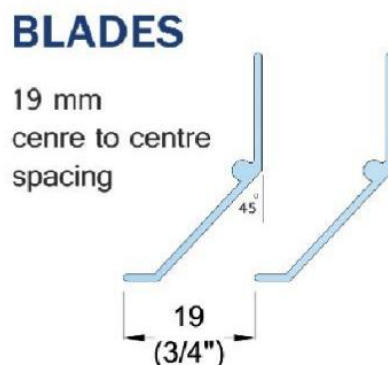
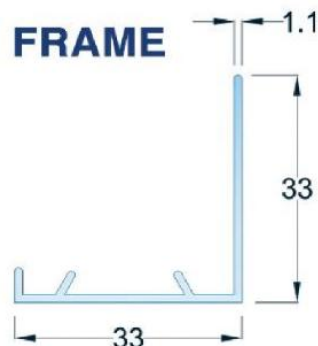
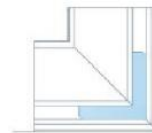
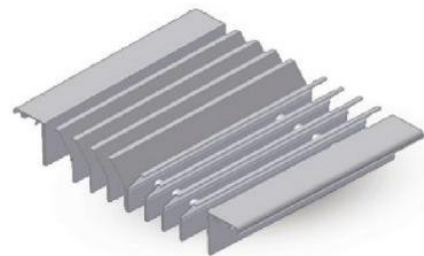

SIZES

Minimum size single unit 100mm x 50mm.

Maximum size single unit 2900mm x 2500mm.

FINISH

Standard mill finish or powder coated

TYPES



(1) ONE WAY LINEAR CEILING DIFFUSERS

MODEL :

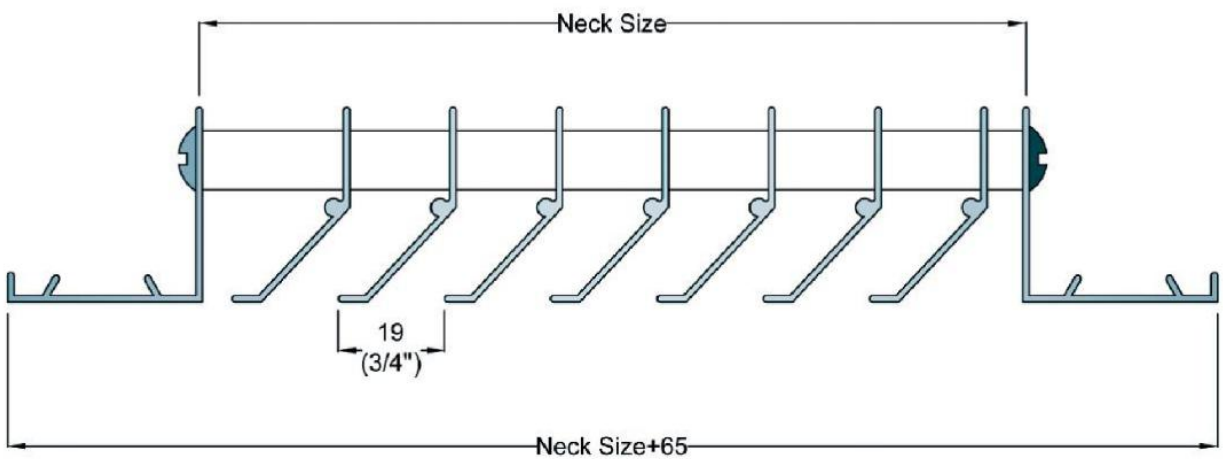

One - Way Linear Diffuser

FLOW DIRECTION

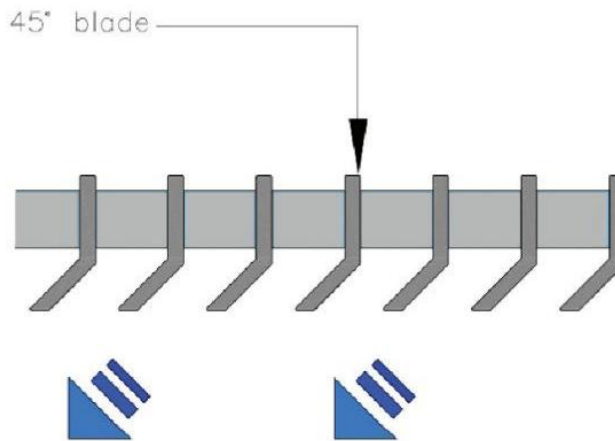



(2) TWO WAY LINEAR CEILING DIFFUSERS

MODEL :

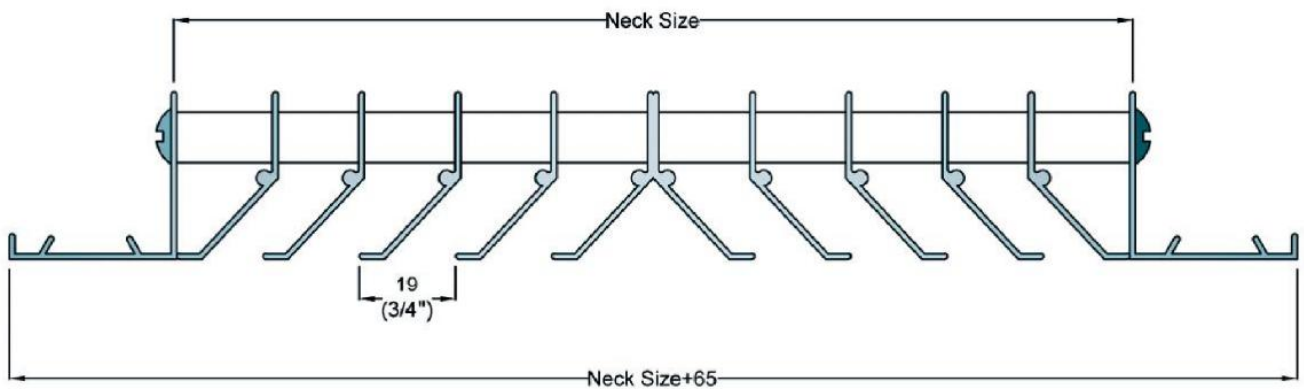

Two - Way Linear Diffuser

FLOW DIRECTION

1

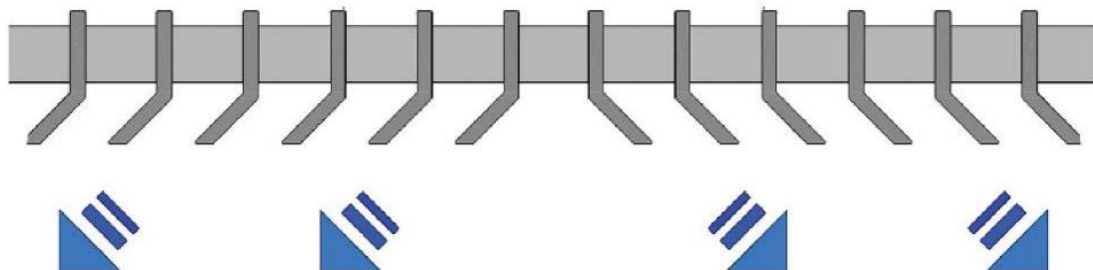

ACCESSORIES

1-OPPOSED BLADE DAMPER

Damper with opposed blades

Depending on application characteristics, an opposed blade damper can be installed on the back side of the linear diffuser.

This damper is a separate item which can be operated by its special tool from the face of the grille. Opposed blade dampers are manufactured from ETIAL-60 norm aluminium extruded profiles. To prevent reflection, they are painted RAL 9005 (matt black) as standard.

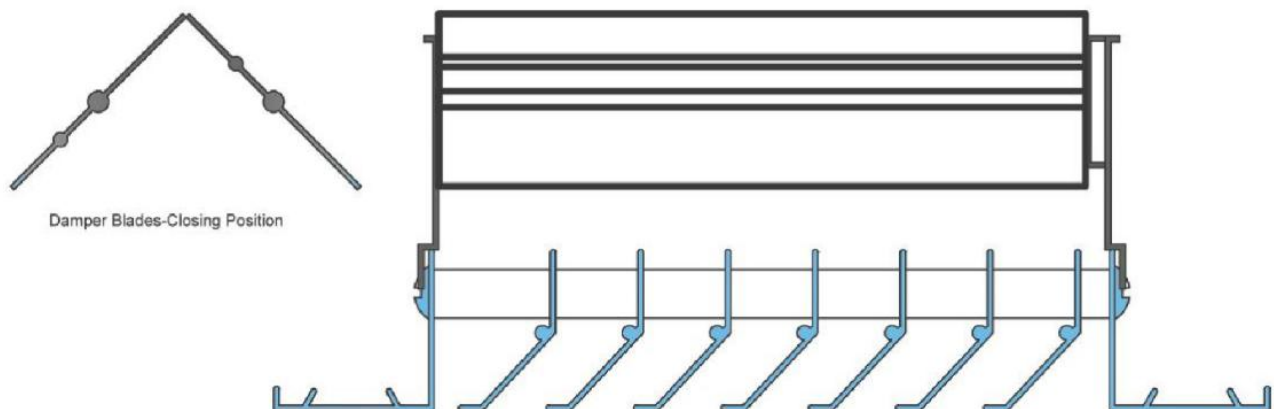
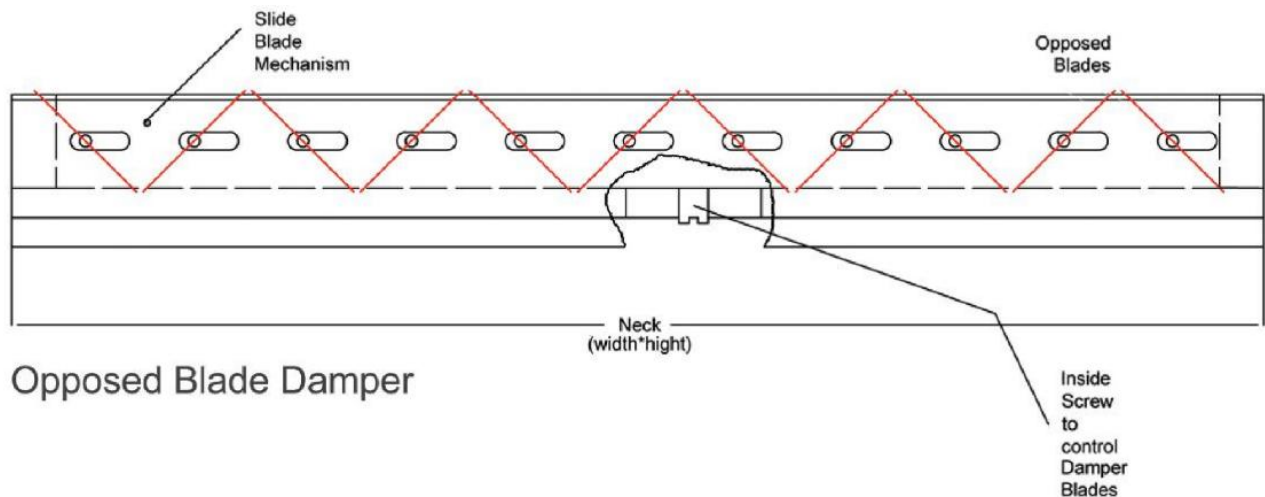

2-PLENUM BOX

The plenum box is used to achieve optimum throw characteristics. It has the inlet either at the top or at one side. Depending on request, a damper can be installed at the inlet, which can be operated internally or externally (has to be specified with the order). The plenum boxes are made from 0.6 mm thick galvanized steel sheets and have 4 hanging brackets on their body. Optionally, a 6 mm thick acoustic foam can be laid inside the plenum box.

OVERVIEW

Designed to facilitate the fitment of ducting to a grille or diffuser.
 plenum boxes are available in top or side entry models with one multiple spigots of any diameter.
 fire rated models & acoustically lined variants are also available.

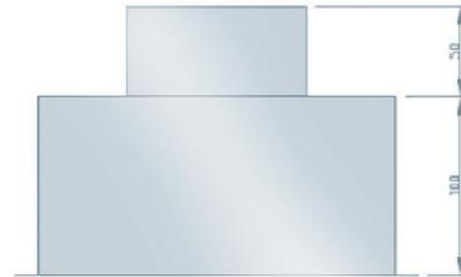

Side entry : Series SEPB



MATERIALS

Galvanised steel throughout

CONSTRUCTION

Break press formed.

Spot welding on spigots.

Sealant used on any joints

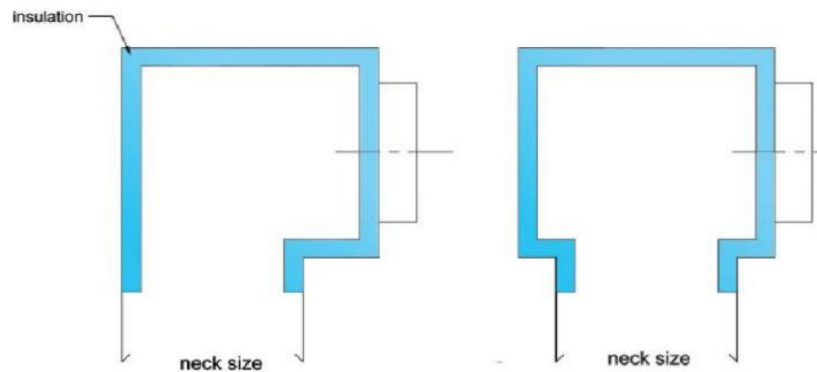

MISSING PIC

FIXING

SCREW



SPRING CLIP

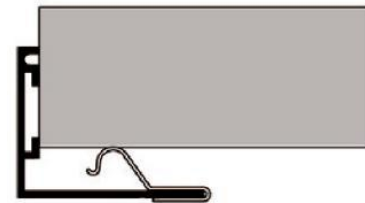

Standard Model Types

- 1 way direction diffuser only NO OBD.
- 2 way direction (equal split) diffuser only NO OBD.
- 1 way direction diffuser WITH OBD fitted.
- 2 way direction (equal split) diffuser WITH OBD fitted.

SELECTION DIAGRAM

Figures based on 1m wide 13 mm fitted with OBD.

10°C cooling application with grille not more than 0.5m below ceiling.

For 6mm blade multiply throw and pressure by 1.2 and increase sound by 2db.

For 20mm pitch multiply throw and pressure by 0.8 and reduce sound by 2db.

For grilles without OBD multiply pressure by 0.9 and reduce sound power level by 2.

